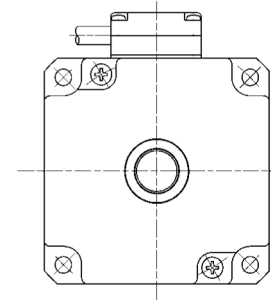

Technical drawing of a 100mm diameter hydraulic cylinder with a 30mm stroke. The drawing shows a front view with a central bore of 55mm diameter and 8 mounting holes. Dimensions include a total width of 100mm, a mounting flange diameter of 75mm, and a mounting hole pitch of 44mm. A 6-M5x7 screw is shown for mounting.

[illegible]

(common specifications)

The diagram shows a cable assembly with the following specifications and labels:

- Motor connector**: Located at the top left, connected to a motor cable.
- Encoder connector**: Located at the bottom left, connected to an encoder cable.
- Motor cable**: The cable segment between the motor and encoder connectors.
- Encoder cable**: The cable segment extending from the encoder connector.
- Dimensions**:
 - 300 ± 30 : Total length of the motor cable segment.
 - (20 max) : Maximum length of the motor cable segment.
 - (12) : Length of the encoder cable segment.



Harmonic Drive LLC
800-921-3332
www.harmonicdrive.net